

SECTION II

TM 9-2320-365-24P

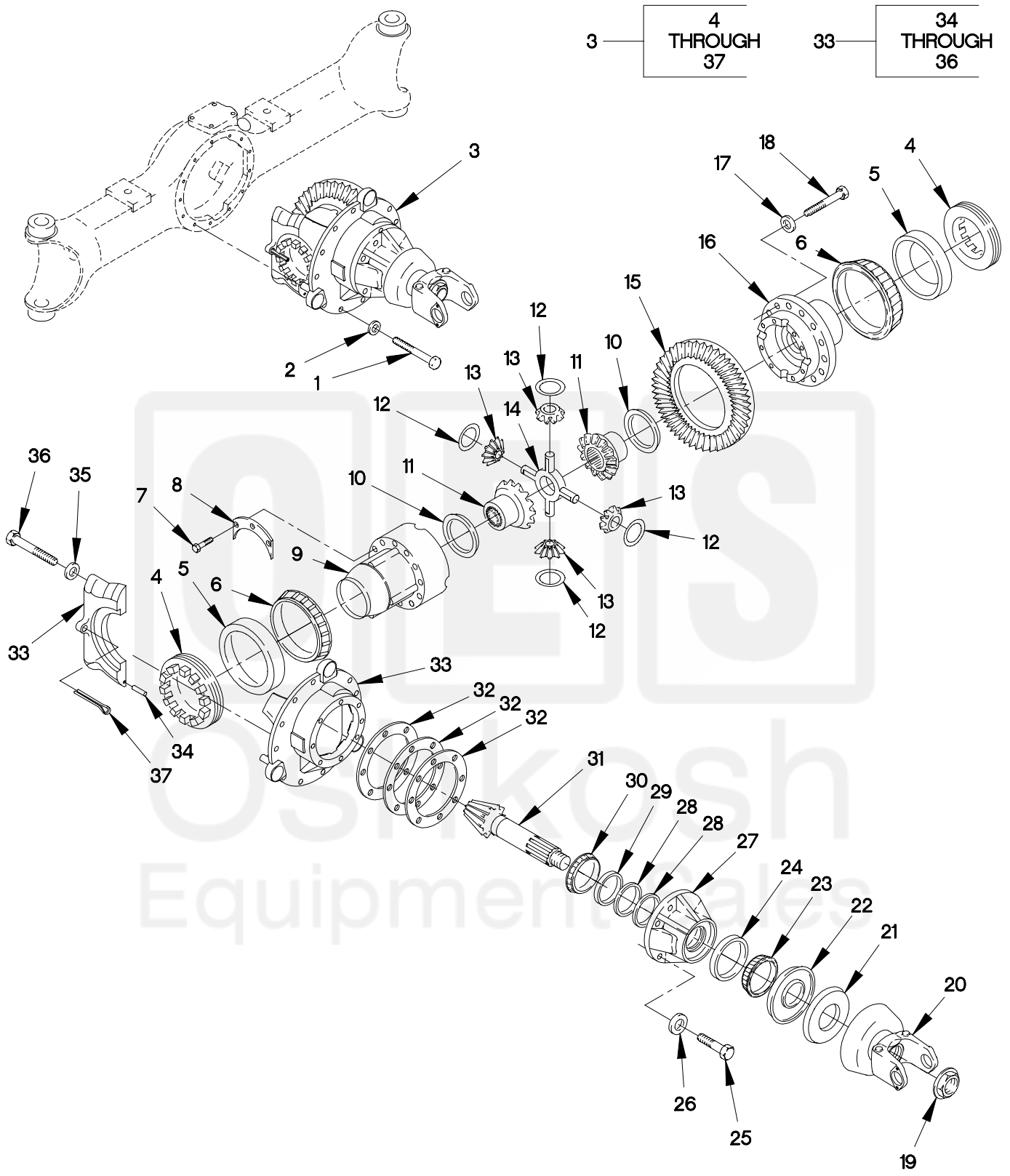

1002A-1C

FIGURE 135. REAR AXLE DIFFERENTIAL CARRIER

SECTION II

TM 9-2320-365-24P

(1) ITEM NO	(2) SMR CODE	(3) CAGEC	(4) PART NUMBER	(5) DESCRIPTION AND USABLE ON CODE (UOC)	(6) QTY
GROUP 1102: DIFFERENTIAL FIG.135 REAR AXLE DIFFERENTIAL CARRIER					
1	KFFZZ	78500	MS212035A-2	SCREW,CAP,HEXAGON H.....	12
2	PAFZZ	78500	1229-C-1511	WASHER,FLAT.....	12
3	PAFHH	78500	A6 3200W1869 3.9	DIFFERENTIAL,DRIVIN.....	1
4	PAHZZ	78500	2214H1100	.BEARING,ROLLER,CYLI.....	2
5	PAHZZ	60038	29620	.CUP,TAPERED ROLLER.....	2
6	PAHZZ	60038	29685	.CONE AND ROLLERS,TA.....	2
7	PAHZZ	78500	MS212080-2	.BOLT,MACHINE.....	12
8	PAHZZ	78500	42X1409	.SPACER,PLATE.....	4
9	PAHZZ	78500	A2-3235H2166	.HOUSING,MECHANICAL.....	1
10	PAHZZ	78500	1229X4106	.BEARING,WASHER,THRU.....	2
11	PAHZZ	78500	2234Q1265	.GEAR,BEVEL.....	2
12	PAHZZ	78500	1229L4276	.BEARING,WASHER,THRU.....	4
13	PAHZZ	78500	2233E1123	.GEAR,BEVEL.....	4
14	PAHZZ	78500	3278X1116	.SPIDER,DIFFERENTIAL.....	1
15	KFHZZ	78500	41102K2-1.95	.AMBOID PINION DRIVE.....	1
16	PAHZZ	78500	3235H2166	.HUB,BODY.....	1
17	PAHZZ	78500	1229-C-1511	.WASHER,FLAT.....	16
18	KFHZZ	78500	MS212035A-2	.SCREW,CAP,HEXAGON H.....	16
19	KFFZZ	78500	40-X-1241	.NUT,SELF-LOCKING,HE.....	1
20	KFFZZ	78500	A-3260-G-111	.YOKE,UNIVERSAL JOIN INTERMEDIATE FRONT AXLE YOKE.....	1
21	KFFZZ	78500	A-1205-F-2502	.SEAL,PLAIN ENCASED.....	1
22	KFFZZ	78500	A1205U2257	.SEAL,PLAIN ENCASED.....	1
23	PAHZZ	78500	66589	.CONE AND ROLLERS,TA.....	1
24	PAHZZ	78500	66520	.CUP,TAPERED ROLLER.....	1
25	PAHZZ	78500	MS210035A-2	.SCREW,MACHINE.....	8
26	PAHZZ	78500	MWA-510	.WASHER,FLAT.....	8
27	PAHZZ	78500	A-3226-A-1275	.HOUSING,BEARING UNI INCLUDES CAGE P/N 3226A1275 AND CUP P/N'S HM813810 AND 66570.....	1
28	KFHZZ	78500	2203-K-9761	.SPACER,PINION,BRG .405 IN (10.500MM).....	V
28	KFHZZ	78500	2203-L-9762	.SPACER,PINION,BRG .406 IN (10.325MM).....	V
28	KFHZZ	78500	2803-A-2783	.SPACER,PINION,BRG .415 IN (10.550MM).....	V
28	KFHZZ	78500	2803-B-2784	.SPACER,PINION,BRG .416 IN (10.575MM).....	V

SECTION II

TM 9-2320-365-24P

(1) ITEM NO	(2) SMR CODE	(3) CAGEC	(4) PART NUMBER	(5) DESCRIPTION AND USABLE ON CODE (UOC)	(6) QTY
28	KFHZZ	78500	2803-C-2785	.SPACER, PINION, BRG .416 IN (10.600MM).....	V
28	KFHZZ	78500	2803-D-2786	.SPACER, PINION, BRG .418 IN (10.625MM).....	V
28	KFHZZ	78500	2803-E-2787	.SPACER, PINION, BRG .419 IN (10.650MM).....	V
28	KFHZZ	78500	2803-S-2775	.SPACER, PINION, BRG .407 IN (10.350MM).....	V
28	KFHZZ	78500	2803-T-2776	.SPACER, PINION, BRG .408 IN (10.375MM).....	V
28	KFHZZ	78500	2803-U-2777	.SPACER, PINION, BRG .409 IN (10.400MM).....	V
28	KFHZZ	78500	2803-V-2778	.SPACER, PINION, BRG .410 IN (10.425MM).....	V
28	KFHZZ	78500	2803-W-2779	.SPACER, RING .411 IN (10.450MM)....	V
28	KFHZZ	78500	2803-X-2780	.SPACER, PINION, BRG .412 IN (10.475MM).....	V
28	KFHZZ	78500	2803-Y-2781	.SPACER, PINION, BRG .413 IN (10.500MM).....	V
28	KFHZZ	78500	2803-Z-2782	.SPACER, PINION, BRG .414 IN (10.525MM).....	V
29	PAHZZ	78500	HM813810	.CUP, TAPERED ROLLER.....	1
30	PAHZZ	78500	HM813844	.CONE AND ROLLERS, TA.....	1
31	KFHZZ	78500	41633K2	.AMBOID GEAR DRIVE.....	1
32	KFHZZ	78500	2803-G-2763	.SPACER, PINION, BRG .003 IN (.076MM).....	V
32	KFHZZ	78500	2803-H-2764	.SPACER, PINION, BRG .005 IN (.127MM).....	V
32	KFHZZ	78500	2803-J-2766	.SPACER, PINION, BRG .010 IN (.254MM).....	V
33	XDHZZ	78500	A2-3200-W-1869	.HOUSING, MECHANICAL.....	1
34	PAHZZ	78500	1246D342	..PIN, SHOULDER, HEADLE.....	4
35	PAHZZ	78500	1229G4401	..WASHER, FLAT.....	4
36	PAHZZ	78500	41X1363	..SCREW, CAP, HEXAGON H.....	4
37	PAHZZ	78500	1199R2176	.PIN, COTTER.....	2

END OF FIGURE